



A powerful and rugged device designed to capture biometric and biographic data in the most challenging environments.

Grabba X-Series is designed and developed for:

- Police & Law Enforcement
- Retail
- Security and Border Protection
- Emergency Response Services
- Travel and Leisure
- Warehousing

Technologies

- Area imaging (1D & 2D) Barcode scanner
- RFID (High Frequency) reader
- MRZ (Passport) reader
- Available with Morpho CBM-E3 FBI Appendix F certified PIV fingerprint scanners
- Contact Smartcard reader (Bottom Slot)
- Contact Smartcard reader (Side Slot)
- Magnetic Stripe reader



About Grabba X-Series.



Barcode scanner: The X-Series can be configured with either the Honeywell N3680 or the top of the range N6600 providing high end scanning capabilities for 1D & 2D barcodes with the option to incorporate LED or laser aiming.

RFID reader: The X-Series can be configured with High Frequency reader or Dual Frequency (Low Frequency and High Frequency).
 • High Frequency: Reads and writes onto 13.56 MHz tokens, cards and tags and can read from and write to the most common RFID cards including DESFire®, Felica™, Mifare® and NFC.
 • Dual Frequency (Low Frequency and High Frequency). It can read and write to 125 KHz for Low Frequency and to 13.56 MHz for High Frequency tokens, cards and tags from HID.

MRZ reader: The Grabba MRZ reader is an Optical Character Recognition (OCR) swipe reader and is able to decode Visas, e-Passports and various National Identity documents.

Fingerprint Scanner: The Morpho CBM-E3, FBI PIV IQS, "PIV" certified" for Android module is certified by the United States FBI. The X-Series can also be provided with Idemia CBM-V3 WSQ license embedded fingerprint scanner for Android devices.

Magnetic Stripe reader : The advanced multitrack reading head can read 1, 2 or 3 track cards. It is extremely fast and reliable with a life expectancy of 1 million passes. Compliant with AAMVA, ISO7810, 7811 and ANSI.

Contact Smart Card reader: Reads national ID cards, transport, security, membership, and store payment cards. Compatible with Siemens, ATmel and ST Microelectronics cards.

Grabba X-Series

General Specifications		Supported Software	
Size w/o tray	167.5 x 74 x 47.5 mm	Smartphone Operating	Android
Weight w/o tray	280 g approx.	Development	SDK available in our Software Program
Charging	USB type C port for the supplied Grabba charger	Free Software	Keyboard Wedge and Demo Application for all platforms
Connectivity	USB type C connection to Smartphone		
Battery Capacity	3000 mAh		
Enclosure	High impact polycarbonate case material All exposed surfaces are rubber coated with a matt finish		

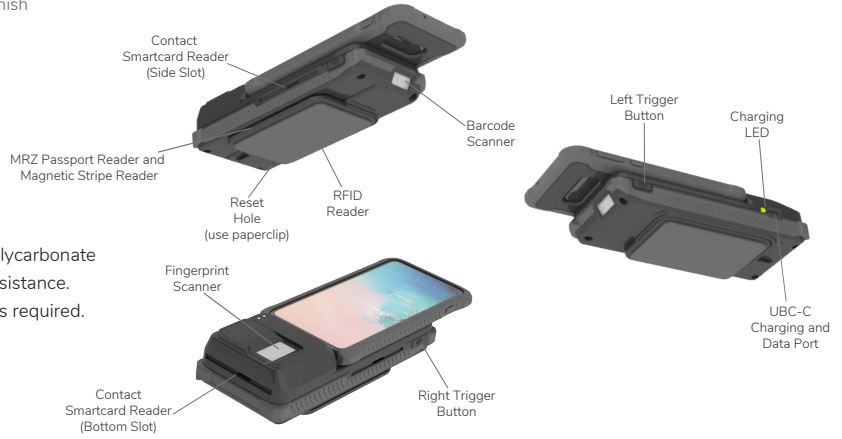

Rugged

The design of the Grabba X-Series has been made with polycarbonate and TPE rubber to endure shocks, vibrations and impact resistance. This makes it ideal for situations where rugged protection is required.

WHY CHOOSE GRABBA

Smart Powered

Every Grabba unit has its own rechargeable Li-Po battery and will charge both the Grabba unit and the attached phone or tablet at the same time.

Extended Battery

An optional extended battery can be installed into a Grabba device that typically more than doubles the battery life.

Secure Connection

The Grabba device plugs into the USB or lightning port allowing all communication and data transfers to be hard-wired, making them more secure

Instant Wake-up

No device pairing required to establish a link. Simply unlock the smart phone or tablet phone and the Grabba is ready to go.

About Grabba.

Grabba enables secure and effective identification and data processing for individuals, businesses and organisations. As a trusted authority in identity technology, Grabba is uniquely positioned to empower the digital transformation of the organisations it serves.

Biometric Technologies

Fingerprint Capture
One to ten fingers in amazing high resolution and accurate detail.

Iris Recognition
Single and dual iris capture and recognition in a portable module.

Facial Recognition
Powerful algorithms for face detection, identification and authentication.

Data Technologies

- Passport Reader
- Magnetic Stripe Reader
- Contact Smartcard Reader
- RFID
- Barcode Reader
- Machine Readable Zone

